

Inquiry / Order sheet

Fax +49 2332 7003-44

Type RA
 Type RM

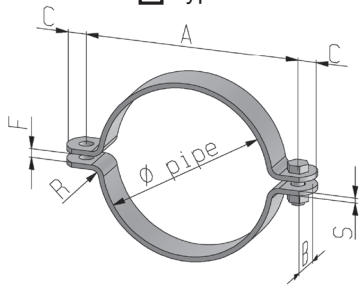

Type RB

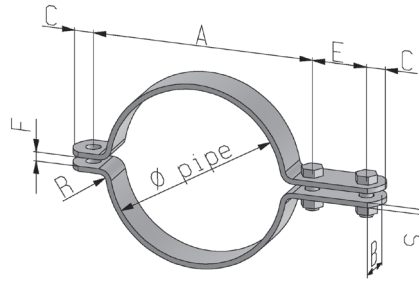

Type	Pipe ϕ	A	B	C	F	E	R	s	bolt size	Material	Surface	Quantity

Type RSB

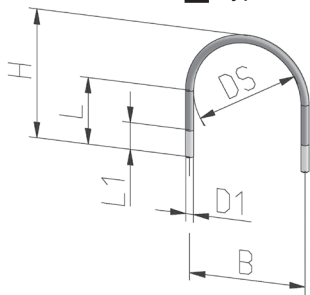

Type	Pipe ϕ	DS	B	D1	H	L	L1		with nuts	Material	Surface	Quantity

Client no.:

Name:

Projekt:

Date:

Company stamp / Signature:

Inquiry / Order sheet

Fax +49 2332 7003-44

Hangers: Options

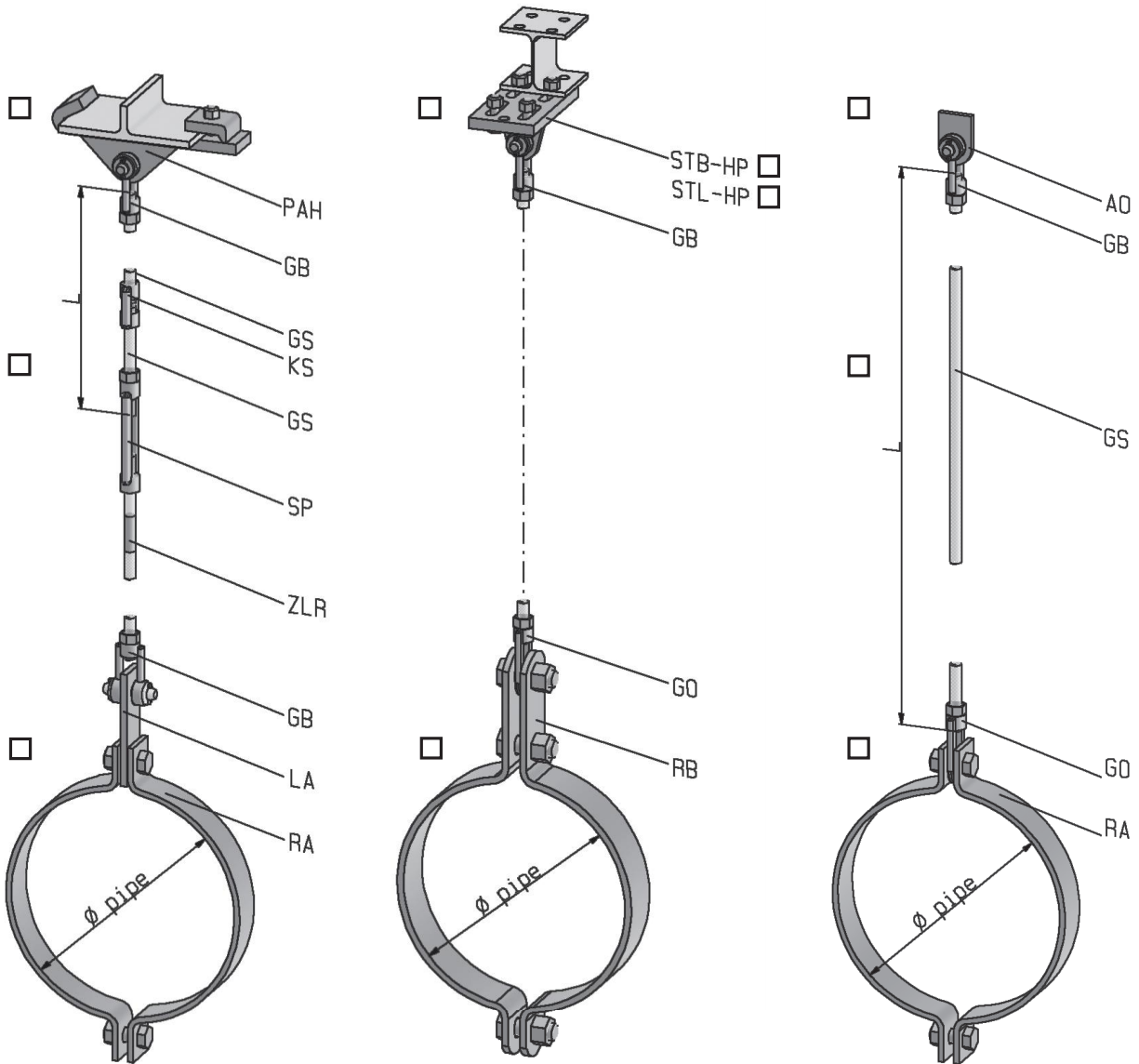

GS	L=
Thread	M
Ø pipe	Ø

Loads

The maximum load of pipe hangers is determined by the load capacity of the weakest link in the hanger assembly. (VGB-R 510-L). This is usually the threaded items, with other components often being capable of supporting several times the load of these parts. The following loads can be assumed for pipe hangers:

M12 - 4,7 kN	M24 - 19,9 kN
M16 - 8,8 kN	M30 - 31,6 kN
M20 - 13,8 kN	M36 - 46,0 kN

Client no.:

Name:

Projekt:

Date:

Company stamp / Signature: